



2000 I-30 E
Greenville, TX 75402

Friday, July 11, 2025

County: Hopkins County

Farmers Electric Cooperative Member: JOSE FLORES
Service Order Number: 2025065630

Greetings:

Farmers Electric Cooperative, Inc. is requesting permission to construct electrical power distribution facilities which will cross County Road 1170 at intersection of 1170 and CR 1158.

Site location map/construction sketches are attached. The construction sketch details the proposed work. The proposed electrical service will be constructed:

- ☒ Overhead - All road crossings will have a minimum vertical clearance of 22 feet.
- ☐ Underground - All underground bore crossings are PVC encased 4' of coverage from the lowest point of the Right of Way.

If you have any questions, please contact me at any time.

Sincerely,

Psalm Harper
pharper@farmerselectric.coop
Engineering Coordinator

Enclosures

County Approval Section:

Approved: ✓ Denied: _____

Authorized Signature:  Date: 7-29-25

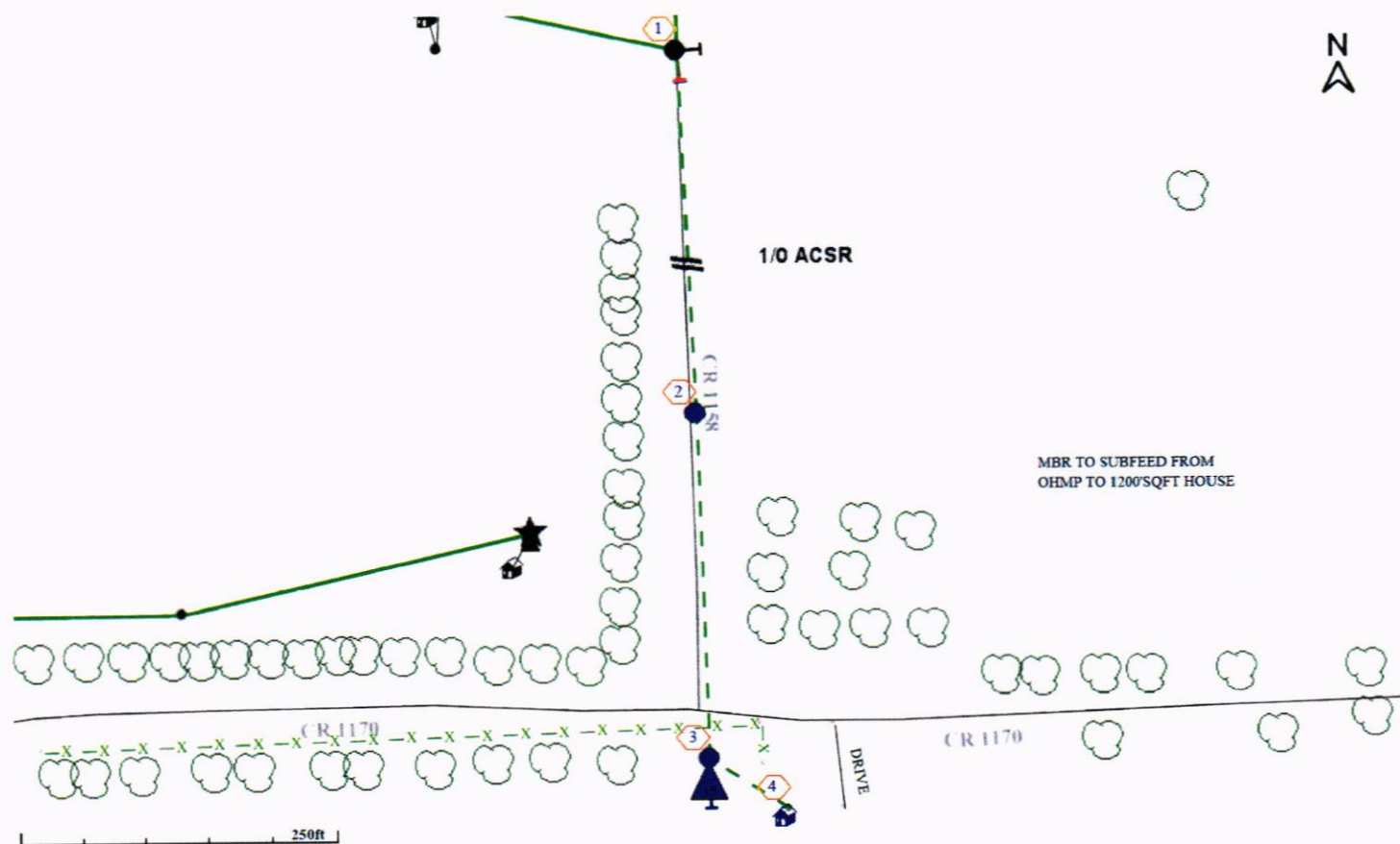



2000 I-30 E
Greenville, TX 75402

Thursday, May 29, 2025

County: Hopkins County

Farmers Electric Cooperative Member: Mackenzie Harris
Service Order Number: 2025045839

Greetings:

Farmers Electric Cooperative, Inc. is requesting permission to construct electrical power distribution facilities which will cross County Road 3532.

Site location map/construction sketches are attached. The construction sketch details the proposed work. The proposed electrical service will be constructed:

- ☒ Overhead - All road crossings will have a minimum vertical clearance of 22 feet.
☐ Underground - All underground bore crossings are PVC encased 4' of coverage from the lowest point of the Right of Way.

If you have any questions, please contact me at any time.

Sincerely,

Kim Harry
kharry@farmerselectric.coop
Engineering Coordinator

Enclosures

County Approval Section:

Approved: ✓ Denied: _____

Authorized Signature:  Date: 7-21-2025

PROTECTIVE DEVICE
OCR 104884



**LARGE

